

K B ELEMENTS

ANGLED PREMIUM KITCHEN HOOD

ELK155A60

USER MANUAL

Please read this manual carefully and retain for future references.

Important Information



Environmental
Recycling

Please recycle the packaging responsibly to support environmental health. Old range hoods contain reusable materials; by recycling them properly, you contribute to environmental protection.



Safety Precautions

Ensure children do not play with plastic film and cardboard boxes to prevent suffocation hazards



Disposal

Make sure to disconnect the power before removing the range hood.

Technical Specifications

Lamp Power	2 x 2W
Motor Power	Motor power: 200W Copper bearing motor
Noise Level	<58dB
Air flow	650 m ³ / hr
Air outlet	Φ160
Rated Voltage	220~240V
Rated Frequency	50/60Hz
Body Dimensions	60 x 40 x 45cm

List of Accessories

	Accessory Name
1	User Manual
2	Smoke Pipe
3	Assembly set
4	Charcoal filter
5	Aluminum filter

Installation Note

For safe and efficient operation, we recommend installing the flat screen hood at a distance of at least 60 cm to 70 cm above an electric induction cooktop or a gas cooktop.

Please also observe the applicable safety regulations as well as the instructions provided by the cooktop manufacturer.

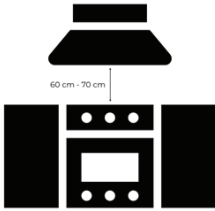

Assembly Instructions

- Drill 3 x 8mm holes to accommodate the bracket. Screw and tighten the bracket onto the wall with the screws provided

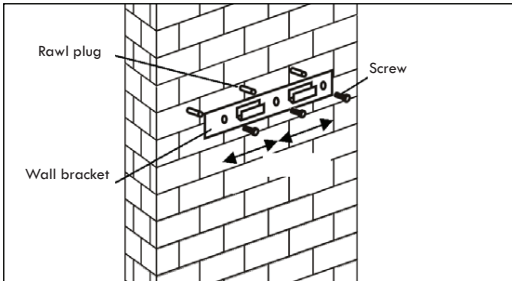

- Leave up the cooker hood and hang onto the wall bracket hook.

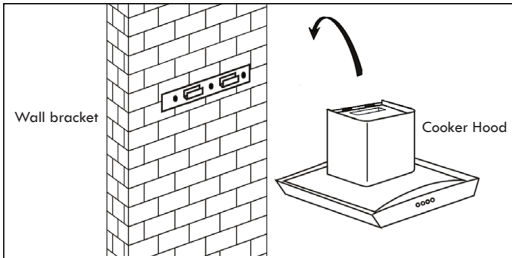

- Fix the one-way-valve to the air outlet of the cooker hood. Then, attached the exhaust pipe onto the one-way-valve as shown below.

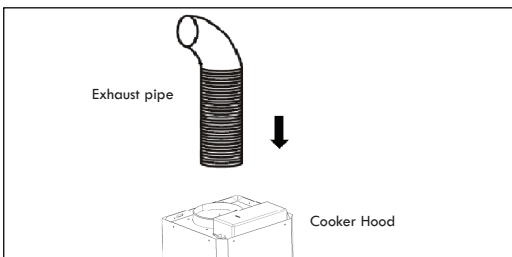

PS: This step applies only to the exhaust airoperation. If you want to use therecirculation mode, please ignore this step.

How to Replace the Charcoal Filter

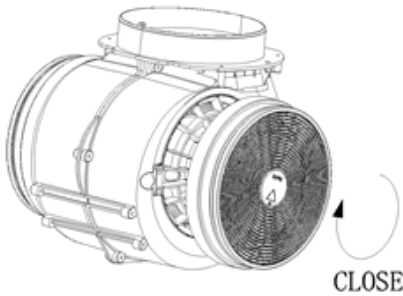

1. Insert the activated carbon filter into the unit and turn it clockwise. Repeat the same process on the other side.
2. Make sure the filter is securely locked.

Note:

The activated carbon filter is located on the back of the filter and should be replaced at least once a year or as needed. The replacement interval depends on the operating time.

Caution: The activated carbon filter should not be washed or reused. It must be replaced after a maximum of 120 operating hours. The carbon filter must not be exposed to heat.

Control Panel

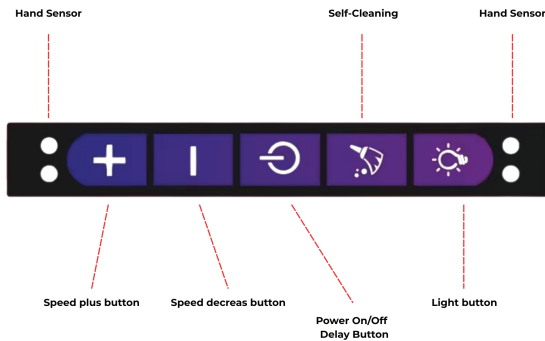

PS: Press and hold the button for 3 seconds to activate the self-cleaning function

PS: When the delay function is activated, the cooker hood will automatically switch off after one minute. This helps to effectively remove any remaining odors from the kitchen

Self-cleaning working principle: After starting, the range hood heats up and melts the grease within 10 minutes. Then the air-drying phase begins for 60 seconds to remove any remaining moisture.

Gesture Control Function

To change the fan speed, simply wave your hand left or right near the control panel. The speed will be adjusted accordingly.

Maintenance

- Before cleaning, turn off the appliance and unplug it.
- Wear protective gloves to avoid cuts during cleaning.
- Avoid water entering electrical components.
- Use only neutral detergents to avoid damaging the hood's protective coating.
- Failure to follow these cleaning guidelines may pose a fire risk.

1- Regular Cleaning

Use a soft cloth dampened with lukewarm, mild soapy water or household cleaner.

Never use metal sponges, chemical cleaners, abrasive materials, or a hard brush to clean the hood.

2- Monthly Cleaning of the Grease Filter

IMPORTANT: Clean the filter every month to prevent fire hazards.

The filter collects grease, smoke, and dust... Therefore, the filter directly affects the efficiency of the range hood.

If not cleaned, grease (potentially flammable) can accumulate in the filter. Clean it with household cleaner.

3- Annual Cleaning of the Charcoal Filter

Applies only to units installed as recirculation models (not vented to the outside).

This filter traps odors and must be replaced at least once a year, depending on how often the range hood is used.

Troubleshooting

Problem	Cause	Solution
Light on, but fan does not work	The fan blade is jammed	Switch of the unit and repair by qualified service personnel only.
	The motor is damaged.	
Both light and fan do not work	Light bulb burn.	Replace the bulb with correct rating.
	Power cord looses.	Plug in to the power supply again.
Serious Vibration of the unit	The fan blade is damaged.	Switch of the unit and repair by qualified service personnel only.
	The fan motor is not fixed tightly.	
	The unit is not hung properly on the bracket.	Take down the unit and check whether the bracket is in proper location.
Suction performance not good	Too long distance between the unit and the cooking plane	Readjust the distance to 65-75cm

ENVIRONMENTAL INFORMATION ON DISPOSAL

This product must not be disposed of with household waste. Please dispose of it at a collection point for electrical and electronic equipment. This will help conserve resources and prevent environmental pollution. This product bears the crossed-out wheeled bin symbol.



To know more about this product, please visit our youtube channel





www.kbelements.de